

FEMALE: ASSEMBLY INSTRUCTIONS OF COLORED RINGS AND PART NUMBERS

ISO 16028

VALVOLA PIANA/ACCIAIO INOX
 FLAT FACE/STAINLESS STEEL
 FLACHDICHTEND/EDELSTAHL
 CLAPET PLAT/ACIER INOX



PUSH FEMALE DOWN

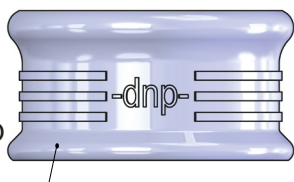
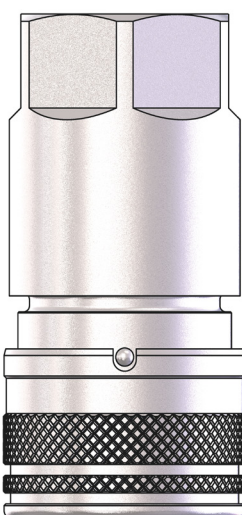

COLORED RING

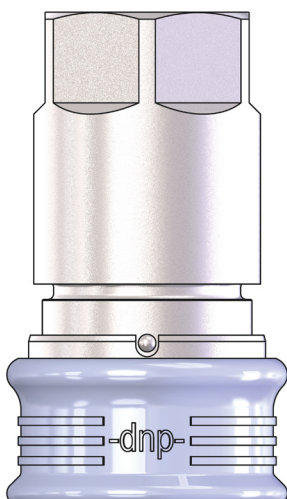

FINAL RESULT

PLTX DN06 - ISO 6.3

CODE	COLOR	MATERIAL
PLT.006.803	●	TPEE
PLT.006.813	●	TPEE
PLT.006.823	●	TPEE
PLT.006.833	●	TPEE
PLT.006.842	●	TPEE
PLT.006.852	○	TPEE
PLT.006.862	●	TPEE
PLT.006.872	●	TPEE
PLT.006.882	●	TPEE
PLT.006.892	●	TPEE

PLTX DN13 - ISO 10

CODE	COLOR	MATERIAL
PLT.013.802	●	TPEE
PLT.013.812	●	TPEE
PLT.013.822	●	TPEE
PLT.013.832	●	TPEE
PLT.013.842	●	TPEE
PLT.013.852	○	TPEE
PLT.013.862	●	TPEE
PLT.013.872	●	TPEE
PLT.013.882	●	TPEE
PLT.013.892	●	TPEE

PLTX DN20 - ISO 12.5

CODE	COLOR	MATERIAL
PLT.019.802	●	TPEE
PLT.019.812	●	TPEE
PLT.019.822	●	TPEE
PLT.019.832	●	TPEE
PLT.019.842	●	TPEE
PLT.019.852	○	TPEE
PLT.019.862	●	TPEE
PLT.019.872	●	TPEE
PLT.019.882	●	TPEE
PLT.019.892	●	TPEE

PLTX DN22 - ISO 16

CODE	COLOR	MATERIAL
PLT.022.802	●	TPEE
PLT.022.812	●	TPEE
PLT.022.822	●	TPEE
PLT.022.832	●	TPEE
PLT.022.842	●	TPEE
PLT.022.852	○	TPEE
PLT.022.862	●	TPEE
PLT.022.872	●	TPEE
PLT.022.882	●	TPEE
PLT.022.892	●	TPEE

PLTX DN25 - ISO 19

CODE	COLOR	MATERIAL
PLT.025.802	●	TPEE
PLT.025.812	●	TPEE
PLT.025.822	●	TPEE
PLT.025.832	●	TPEE
PLT.025.842	●	TPEE
PLT.025.852	○	TPEE
PLT.025.862	●	TPEE
PLT.025.872	●	TPEE
PLT.025.882	●	TPEE
PLT.025.892	●	TPEE

PLTX DN30 - ISO 25

CODE	COLOR	MATERIAL
PLT.030.802	●	TPEE
PLT.030.812	●	TPEE
PLT.030.822	●	TPEE
PLT.030.832	●	TPEE
PLT.030.842	●	TPEE
PLT.030.852	○	TPEE
PLT.030.862	●	TPEE
PLT.030.872	●	TPEE
PLT.030.882	●	TPEE
PLT.030.892	●	TPEE

MALE: ASSEMBLY INSTRUCTIONS OF COLORED RINGS AND PART NUMBERS

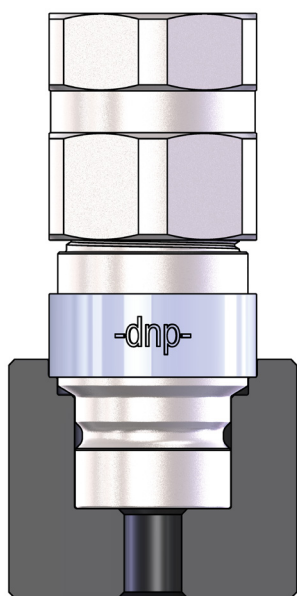
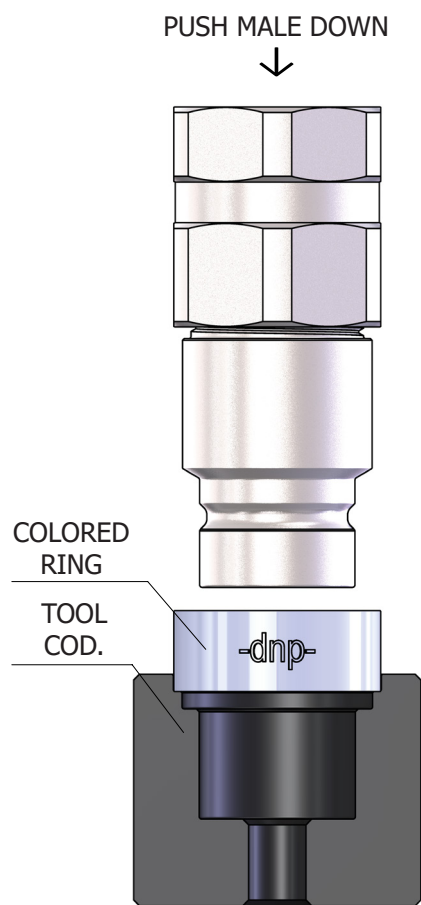

FINAL RESULT

TOOL COD.

PLT.006.8X3

PLTX DN06 - ISO 6.3

CODE	COLOR	MATERIAL
PLT.006.803	Red	PP
PLT.006.813	Yellow	PP
PLT.006.823	Green	PP
PLT.006.833	Blue	PP
PLT.006.843	Black	PP
PLT.006.853	White	PP
PLT.006.863	Grey	PP
PLT.006.873	Orange	PP
PLT.006.883	Purple	PP
PLT.006.893	Brown	PP

TOOL COD.

PLT.013.8X3

PLTX DN13 - ISO 10

CODE	COLOR	MATERIAL
PLT.013.803	Red	PP
PLT.013.813	Yellow	PP
PLT.013.823	Green	PP
PLT.013.833	Blue	PP
PLT.013.843	Black	PP
PLT.013.853	White	PP
PLT.013.863	Grey	PP
PLT.013.873	Orange	PP
PLT.013.883	Purple	PP
PLT.013.893	Brown	PP

TOOL COD.

PLT.019.8X3

PLTX DN20 - ISO 12.5

CODE	COLOR	MATERIAL
PLT.019.803	Red	PP
PLT.019.813	Yellow	PP
PLT.019.823	Green	PP
PLT.019.833	Blue	PP
PLT.019.843	Black	PP
PLT.019.853	White	PP
PLT.019.863	Grey	PP
PLT.019.873	Orange	PP
PLT.019.883	Purple	PP
PLT.019.893	Brown	PP

TOOL COD.

PLT.022.8X3

PLTX DN22 - ISO 19

CODE	COLOR	MATERIAL
PLT.022.803	Red	PP
PLT.022.813	Yellow	PP
PLT.022.823	Green	PP
PLT.022.833	Blue	PP
PLT.022.843	Black	PP
PLT.022.853	White	PP
PLT.022.863	Grey	PP
PLT.022.873	Orange	PP
PLT.022.883	Purple	PP
PLT.022.893	Brown	PP

TOOL COD.

PLT.025.8X3

PLTX DN25 - ISO 19

CODE	COLOR	MATERIAL
PLT.025.803	Red	PP
PLT.025.813	Yellow	PP
PLT.025.823	Green	PP
PLT.025.833	Blue	PP
PLT.025.843	Black	PP
PLT.025.853	White	PP
PLT.025.863	Grey	PP
PLT.025.873	Orange	PP
PLT.025.883	Purple	PP
PLT.025.893	Brown	PP

TOOL COD.

PLT.031.8X3

PLTX DN30 - ISO 25

CODE	COLOR	MATERIAL
PLT.031.803	Red	PP
PLT.031.813	Yellow	PP
PLT.031.823	Green	PP
PLT.031.833	Blue	PP
PLT.031.843	Black	PP
PLT.031.853	White	PP
PLT.031.863	Grey	PP
PLT.031.873	Orange	PP
PLT.031.883	Purple	PP
PLT.031.893	Brown	PP